

## **Allotments & Land Report 20<sup>th</sup> October 2025**

### **ITEM 9: NORMAN ROAD AND NASH GARDENS ALLOTMENTS**

Invoices have gone out for the new Allotment year.

The waiting list numbers are 29 at Norman Road and 30 at Nash Gardens. On average it takes 3.5 years to reach the top of the list.

**Decision required whether to re-open the list for the year October 2025-October 2026.**

### **ITEM 10: MOCKETT'S WOOD**

Neil has made a huge amount of progress with the dead hedging at the woods, as you would have seen in his newsletters.

He will now be making task lists for the volunteers so that there is more structure to their time spent at the woods.

We have had an online meeting with the Woodland Trust which was very informative.

We are currently waiting for the tree survey to be undertaken.

Please see the options presented for the path surfacing.

**Officer's recommendation is option 1 – this path can be undertaken inhouse and in small sections, so can be spread over a period of time. The materials are more environmentally friendly and it allows for growth underneath the boardwalk. The path can easily be repaired.**

**Decision required from the Committee on a path option**

### **ITEM 11: CULMER'S AMENITY LAND**

The Civic & Support Officer's (CSO) wildflower project has proved a great success after a few initial hiccups. The CSO is in liaison with CT10 Charities regarding the next steps in planting. This is fully reported on under the Environment Committee.

NGL Boxgreen continue with the Grounds Maintenance of this land.

We are currently waiting for the tree survey to be undertaken.

### **ITEM 12: PIERREMONT PARK GROUNDS**

Boxgreen NGL continue with the ground's maintenance of the gardens.

We are currently waiting for the tree survey to be undertaken.

Hedging – the hedging at the rear of the portico, running along the railings has not been successful. Plants have been fed, composted, bark mulched and watered on a regular basis and over half of the plants have also been replaced all at the contractors own expense.

**It is the Officer's recommendation to not replace this hedging due to the expense, also, the railings are not unattractive and in need of covering up. It was initially put in place to keep dogs out of the area during wedding receptions, but as the gate will be removed to allow better access, it does not seem worthwhile to continue having a hedge in place.**

# ITEM 13: LAND UNDER LICENCE

Cllr Pressland's proposals:

<u>Key for:- Balmoral Gardens (Fragrant / Herbal / Edible)</u>		
	<u>Raisee Bees</u>	<u>Number Plants</u>
1) Rosmarinus 'Miss Jessops Upright'		14
2) Santolina etrusca		10
3) Hyssopus officinalis		10
4) Artemisia abrotanum		6 or 3
5) Artemisia <sup>(cand. of)</sup> 'Powis Castle'		+ 3
6) Santolina rosmarinifolia		6
7) Teucrium chaemadrys		75
8) Calamintha nepeta		16
9) Aloysia citrodora		6
10) Asphodeline liburnica		18
11) Asphodelus albus		18
12) Dianthus Spring Star (clove pink)		23
13) Salvia officinalis 'Icterina'		12
14) Myrtus communis		4
15) Melichrysium italicum 'Korma'		12
16) Origanum 'Rosenkuppel'		30
17) Origanum 'Dingle Fairy'		20
18) Origanum 'Bristol Cross'		20
19) Artemisia pontica		6

Please Note:-  
 Numbers 1/6/9/14 purchase as 5L containers  
 other key numbers purchase in P9 or 1L containers.

# Balmoral Gardens Raised Beds

Existing Bay

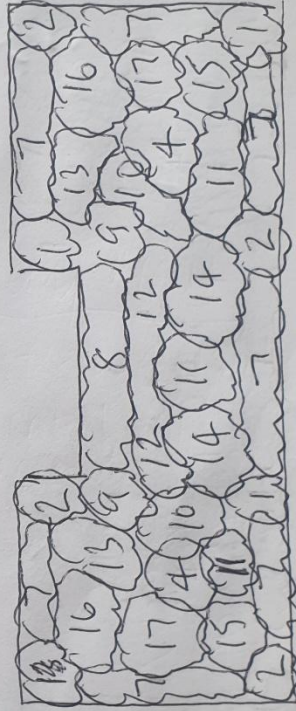
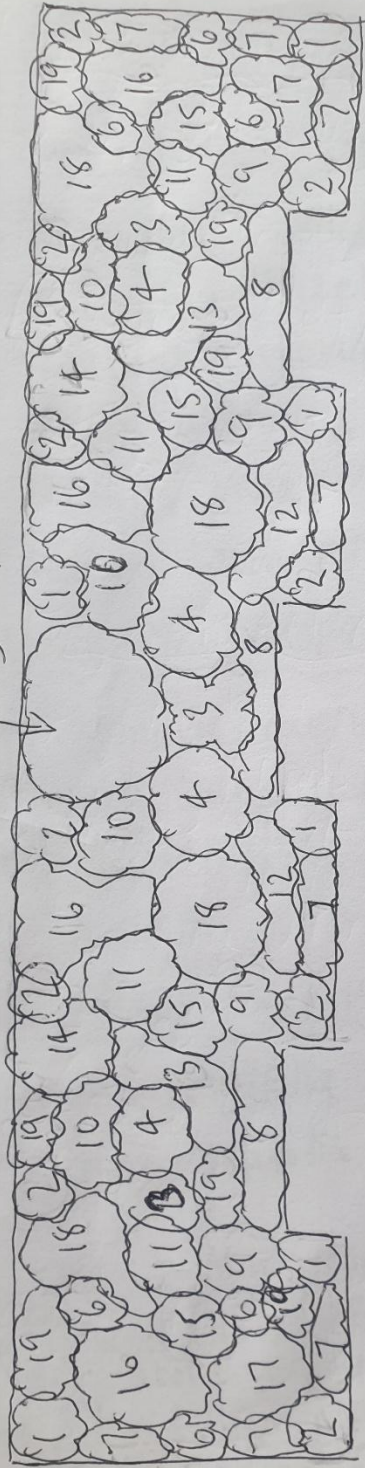



## Balmoral Gardens (Continued)

Just outside of shrubs on ground on margins to site

- x 15 Tulbaghia 'Cosmic'
- x 15 Tulbaghia 'Hazel'
- x 15 Tulbaghia violacea 'Alba'
- x 15 Allium ursinum
- x 12 Fragaria vesca
- x 6 Mentha Lavender Mint (Jekkas Nursery)

### Under Tree Canopies

- x 9 Polemonium caeruleum (Jacobs ladder)
- x 30 Primula vulgaris (wild primrose)
- x 12 ~~sym~~ Symphytum officinalis (less vigorous cvs 'Bodring 14')

### Dot plants near entrances

- x 2 Mentha longifolia Buddleia Mint Group (Jekkas)
- x 2 Mentha longifolia Jekkas

Please Note - Mints should always be submerged in containers (allowing for ability to plant to expand)  
(All plants above suggest purchase in 9 or 1L containers.)  
Semi Pollard dying sycamore and train in rambling rose Rosa Frances E Lester  
(need to discuss with neighbour)

Remove central rose bed (now too small)

## Behind Hedges Inject in beds

*Ferula communis*

Objective  
To gain height and statuesque  
stance (mimicry in a more  
informal way a Victorian planting feel)

## Nuckells

Through existing shrubs

*Clematis viticella* 'Etoile de Hollande' x 2

*Clematis tetensis* 'Diana' x 2

Injection in front of, and between shrubs

*Onopordum acanthium*

*Euphorbia mellifera*

David Austin English Rose examples

*Rosa* 'Kew Gardens'

*Rosa* 'Queen of Sweden'

*Rosa* 'Desdemona'

Remove central rose bed (new roses only in new areas)



W Haplopappus glutinosus

'Carpet of Snow'

(Whilst T/V establish use Alyssum to fill gaps and create initial impact)

Existing low Euonymus Hedge

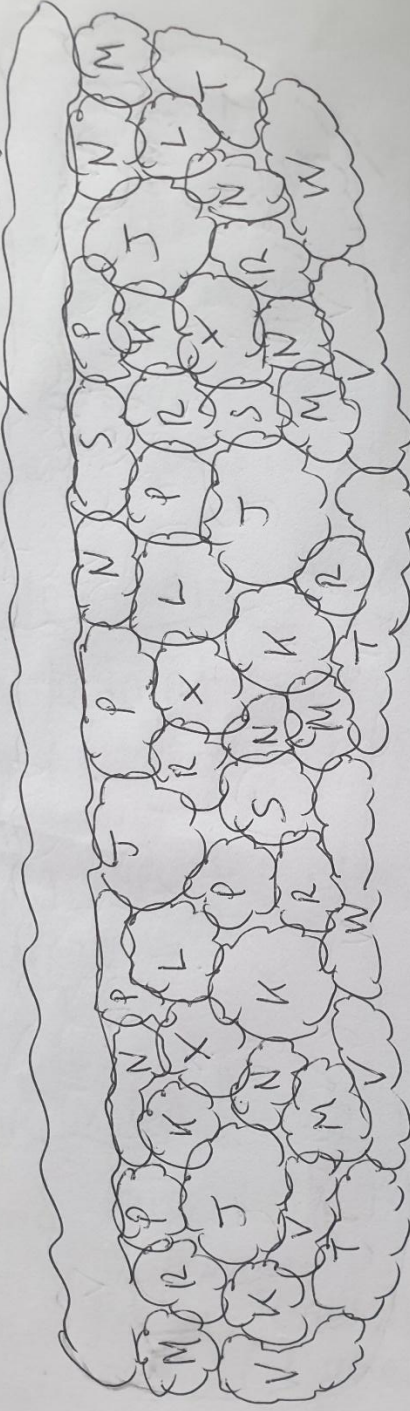

X Ferula communis

J Romneya coulteri

K Muhlenbergia rigens

L Eryngium giganteum

M Glaucium flavum

N Asphodelus albus

P Dipsacus fullonum

R Linaria 'peachy'

S Linaria (Lemon Twist)

T Euphorbia myrsinites

V Melianthemum 'The Bride'

Alongside Hedges/Shrubs Partial Shade but Dry  
on Victoria Gardens

x9 Anemone hepensis 'Madspan Abundance'  
x9 Anemone Multifida 'Annabelle White'  
x30 Liriope muscari  
x30 Epimedium x versicolor 'Sulphureum'

Inject to enhance Rockery Areas

Dot plants to inject further texture, levels,  
flowering periods and elemental structure in  
dormant season -

Cistus x pulverulentus 'Sunset'	x 4
Cistus purpureus -	x 4
Santolima virens -	x 4

Victoria Gardens Boundary Shrubs / Trees

Enhance these with injections of examples:-

Clematis 'Jackmanii'	x 2
Clematis texensis 'Gravetye Beauty'	x 2
Clematis texensis 'Duchess of Albany'	x 2
Clematis 'Arabella'	x 2

The gardeners have been working hard over the summer ensuring that all areas were kept watered and the grass cut, plus weeding the beds to ensure that they looked good throughout the season.

Now we are into the autumn, they are cutting shrubs etc back. This autumn they will be concentrating on the Louisa Bay end of the gardens, which needs a lot of reducing and clearance. The bedding at the War Memorial has been removed and this will be replaced prior to

Remembrance Sunday, considering any works that may be undertaken to the memorial. Bedding will also be planted in the two small circular beds near the Charles Dickens public house. They will also be undertaking planting in the Balmoral raised beds, incorporating the planting plans produced by Cllr Pressland.

The gardeners are at capacity now but able to keep on top of the workload, whilst slowly introducing changes such as those at Balmoral.

Cllr Pressland has produced plans for the whole area, which will obviously take several years to get round to undertaking and working into forthcoming years budgets. We need to take into account that we only have three members of staff – all part time, our limited equipment and storage, so all future ideas need to be well planned, down to how many plants we can order and how long it will take to plant them and also the time required for the continued upkeep and maintenance of these areas.. Also, larger areas where grounds maintenance needs to be undertaken using machinery and large loads of materials will need to be undertaken by a contractor, so these costs need to be borne in mind.

We do not have any confirmation on Nuckells Gardens and the volunteers there are still undertaking all of the work. It maybe that all they require is a few days help from us to get the gardens back in order, before continuing work themselves, so currently, we are not looking at taking this area on.

If members wish to look at incorporating other areas into our cultivation licence with TDC, we must remember that our gardeners are at capacity, so additional staffing needs to be considered and included in next year's budget.

**Officer's Recommendation would be to continue with our current areas this year and concentrate on improving Balmoral raised beds and Lousia Bay end, whilst still keeping up with the care and maintenance of all other areas under licence. Plans for the planting of the grassed area (area with boxed memorial) which will include the hire of a contractor, plus the increased upkeep and maintenance of such to be planned to take into account additional man hours required and reported at the October 2026 meeting.**

#### **ITEM 15: STAFFING**

To discuss the extension of contract, increase of hours and salary of the Woodland Officer.